

# Red Fiber Washer & Grounding (Earth) Tags Accessories - NPT / Metric Sizes - Ex-e





Ex-d EXIOS  
Cable Glands

Ex-d Nickel Plated Brass &  
Stainless Steel Glands

Ex-e  
Nylon Glands

Ex-e Multi-Hole &  
Romex Glands

Reinforced Nylon - Red Fiber Seal Rings - NPT		
Part Numbers	Seal Ring Thickness	Fits Thread Size
-76°F to 221°F (-60°C to 105°C)		Page 59 for Thread Specs
(Standard)		
SR-09-FN	1.5	3/8" NPT
SR-13-FN	1.5	1/2" NPT
SR-21-FN	1.5	3/4" NPT
SR-29-FN	1.5	1" NPT
SR-54-FN	1.5	1 1/4" NPT
SR-36-FN	1.5	1 1/2" NPT
SR-20-FN	1.5	2" NPT
SR-52-FN	1.5	2 1/2" NPT
SR-30-FN	1.5	3" NPT

Reinforced Nylon - Red Fiber Seal Rings - Metric		
Part Numbers	Seal Ring Thickness	Fits Thread Size
-76°F to 221°F (-60°C to 105°C)		Page 59 for Thread Specs
(Standard)		
SM-16-FN	1.5	M16 x 1.5
SM-20-FN	1.5	M20 x 1.5
SM-25-FN	1.5	M25 x 1.5
SM-32-FN	1.5	M32 x 1.5
SM-40-FN	1.5	M40 x 1.5
SM-50-FN	1.5	M50 x 1.5
SM-63-FN	1.5	M63 x 1.5
SM-75-FN	1.5	M75 x 1.5

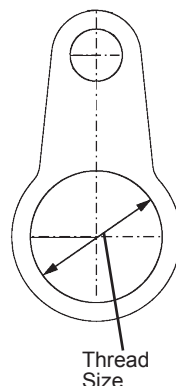

Raw Brass (BB) & Nickel Plated Brass (BR) Grounding (Earth) Tags are installed between the cable gland & equipment to provide proper grounding.

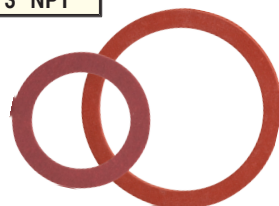

Grounding (Earth) Tags	
Part Numbers	Thread Type & Size
-4°F to 203°F (-20°C to 95°C)	Page 59 for Thread Specs
 (Raw Brass & NPB)	
TN-09-BB	3/8" NPT
TN-13-BB	1/2" NPT
TN-21-BB	3/4" NPT
TN-54-BB	1 1/4" NPT
TN-36-BB	1 1/2" NPT
TN-20-BB	2" NPT
TN-52-BB	2 1/2" NPT
TN-30-BB	3" NPT
TN-13-BR	1/2" NPT
TN-21-BR	3/4" NPT
TN-29-BR	1" NPT
TM-20-BB	M20 x 1.5
TM-25-BB	M25 x 1.5
TM-32-BB	M32 x 1.5
TM-40-BB	M40 x 1.5
TM-50-BB	M50 x 1.5
TM-63-BB	M63 x 1.5
TM-75-BB	M75 x 1.5

# Serrated Washers & Shrouds - Accessories NPT / Metric Sizes - Ex-e





Ex-e Nickel Plated Brass &  
Stainless Steel Glands

Ex-e EMI / RFI Nickel  
Plated Brass Glands

Ex-e / Ex-d  
Accessories

Serrated Washers - NPT	
Part Numbers	Fits Thread Size
-4°F to 203°F (-20°C to 95°C)	Page 59 for Thread Specs
 (Stainless Steel: AISI 316)	
WN-09-SS	3/8" NPT
WN-13-SS	1/2" NPT
WN-21-SS	3/4" NPT
WN-29-SS	1" NPT
WN-54-SS	1 1/4" NPT
WN-36-SS	1 1/2" NPT
WN-20-SS	2" NPT
WN-52-SS	2 1/2" NPT
WN-30-SS	3" NPT

Serrated Washers - Metric	
Part Numbers	Fits Thread Size
-4°F to 203°F (-20°C to 95°C)	Page 59 for Thread Specs
 (Stainless Steel: AISI 316)	
WM-16-SS	M16 x 1.5
WM-20-SS	M20 x 1.5
WM-25-SS	M25 x 1.5
WM-32-SS	M32 x 1.5
WM-40-SS	M40 x 1.5
WM-50-SS	M50 x 1.5
WM-63-SS	M63 x 1.5
WM-75-SS	M75 x 1.5

Shroud - NPT & Metric		
Part Numbers	Fits EXIOS Size	Fits Thread Size
 (PVC)	Page 59 for Thread Specs	
SE-2K-PV		
SE-2M-PV	20-2	1/2" NPT / M20
SE-2L-PV	20-3	1/2" NPT / M25
SE-25-PV	25	3/4" NPT / M25
SE-32-PV	32	1" NPT / M32
SE-40-PV	40	1-1/4" NPT / M40
SE-50-PV	50	2" NPT / M50
SE-63-PV	63	2-1/2" NPT / M63
SE-75-PV	75	3" NPT / M75

Provides additional weather and corrosion protection for Cable Glands in Hazardous locations.

